

SONAR TAG

Uni-Clip

S-LU25-S/S-LU25-L

Protections for eyewear

Absolutely new idea! - Anti-theft system designed to be attached onto thin to medium and high temple arms.
Smart design - **ONE** single structure. Very easy to use in the attaching and the detaching.



New Product

Characteristics

Anti-theft protection Re-usable

It prevents shop lifting. It is particularly used for eyewear. One side can be personalized with logo, stickers, price adhesive labels or bar-codes.

Design

Smart, soft and small. It doesn't alter the design of the protected item nor hamper its wearing.

Structure: 1 piece

It can be used more than once (re-usable), therefore it allows to recover the investment cost. The structure is strong with soft protective lining.

Use

The **attaching** and the **detaching** are carried out by the authorized tool which allows a quick operation even with large quantities of frames.

Models

S-LU25-S

S-LU25-L

EAS Thecnologies

- Acousto-magnetic
- Electro-magnetic

Authorized tool

To **attach** and **detach** the **S-LU25-S** and **S-LU25-L** Sonar tag.

It is available with fastener screws and incorporated technology as well.

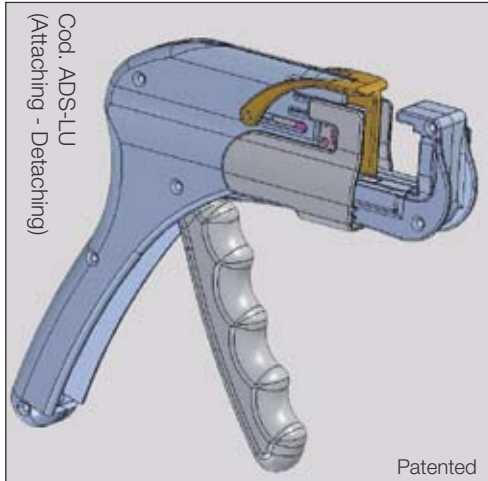

Attaching

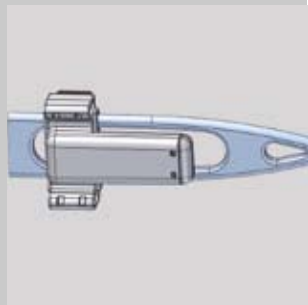

Insert the temple arm between the tag and the clip (the smaller part) turned towards the inner part.

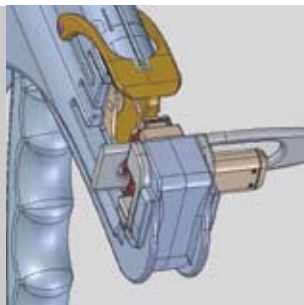

Lay correctly the temple arm with the already mounted tag in the **A** housing (Attaching).

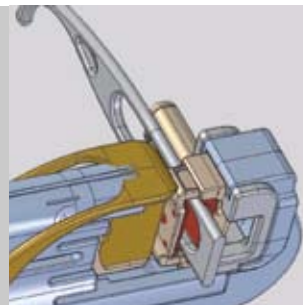

Set the tool in the **A** position (Attaching). Place the temple arm with the tag in the housing. Press the lever in order to fix firmly the tag to the temple arm.

Detaching

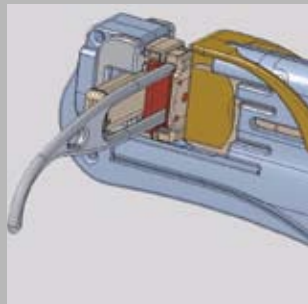

Set the tool in the **R** position (Detaching). Place the temple arm with the tag into the housing. Press the lever in order to pull the tag apart from the clip.

Note:

The correct lining up of the tag into the tool avoids damage during the **Attaching** and the **Detaching** operations.